

Sales Guide

SP 8400DN

RICOH
imagine. change.

A3 B&W Printer

Printer



SP 8400DN

60
ppm B&W



Contents:

1.	Introduction	Page 3
2.	Smart Operation Panel	Page 4
3.	Sales Highlights	Page 5
4.	Product Positioning	Page 7
5.	Configuration	Page 8
6.	Target Markets	Page 10
7.	Key Features	Page 11
8.	Specifications	Page 14
9.	EDP Codes	Page 18
10.	Service and Supplies	Page 19

This sales guide is to be used by sales staff as a training aid. It is not a sales tool and should not be shared with customers. Whilst care has been taken to ensure that the information provided in this guide is accurate, no liability will be accepted for errors or omissions.

1. Introduction

Ricoh's new A3 B&W printer is designed for mission-critical print applications. Effortlessly productive, the SP 8400DN produces professionally presented black and white output at pace. The first 1,200 dpi print is ready in just 2.7 seconds and multi-page document sets are delivered a rate of 60 pages per minute.

The new printer's robust design, class-leading first print speed and 60 ppm productivity make it ideal for mission-critical environments where the printer needs to support the business process and not become a bottleneck.

To save time and automate handling, SP 8400DN can fold, punch and staple. Finishing options include an internal folding unit and a hybrid staple/stapleless finisher, both of which are unique in this class. The hybrid staple/stapleless finisher neatly crimps smaller document sets, automatically switching to a conventional staple finish for larger documents sets.

Combining power and performance, the SP 8400DN is the perfect solution for demanding vertical market applications. It supports IPDS printing and can be used as a dedicated production facility for high value / high volume transactional documents. It can also be deployed as a shared departmental facility in the general office.

Not only is the SP 8400DN the fastest A3 B&W printer in its class, it is also the most environmentally sustainable. The printer recovers from low-energy sleep mode (0.5W) in under three seconds and, with a class leading TEC rating (Typical Electricity Consumption) of just 2.8KWh, will help to cut energy consumption and limit carbon emissions.

The SP 8400DN is the first A3 B&W printer to feature Ricoh's award winning Smart Operation Panel. The intuitive interface

supports PC-less printing. Using the large 10.1" panel, it is easy to preview and print documents from a variety of sources, including the web and USB/SD card memory, as well as from the printer's own internal file server.

Ricoh's Smart Device Connector app also allows users to connect their smart phones and tablets. To connect, the user only needs to touch their smart device on the printer's NFC tag or scan the displayed QR code. Having connected their smart device, they can print documents received via email or social media.

The new printer shares the same appearance, operating system and peripherals as Ricoh's latest A3 MFPs and can be installed as part of an MFP + P solution that encompasses black-and-white and colour. Users moving from one device to another are instantly familiar with Ricoh's intelligent print technology.



Smart Operation Panel

Ricoh's award winning, Smart Operation Panel is a productive and easy-to-use document systems that streamlines complex workflows, automate time-consuming tasks, establish administrative control and safeguard information security.

The Smart Operation Panel offers a major point of differentiation. It expands functionality and makes our devices easier to use. Providing a uniform and intelligent platform, it also helps to build customer loyalty and encourage repeat orders.

The extra-large 10.1" Smart Operation Panel delivers a truly tactile and immersive user experience. It is brightly lit, easy to use and instantly responsive. It provides a simple visual interface that speeds operation. To view a widget or open an application, the user simply taps the appropriate icon.

It is equipped with a web browser that allows users to view and print web content, and a Wi-Fi card, which improves access and supports a mobile workforce by allowing users to interact seamlessly using their smart devices.

Users can customise the interface to their own requirements, changing the wallpaper, dragging shortcuts to the home screen, installing useful widgets and downloading additional workflow applications directly from Ricoh's Application Site.

The Application Site icon on the Smart Operation Panel provides instant access to additional workflow applications and firmware updates. Browsing the site, users can configure their devices and install the latest time-saving workflow applications.

Ricoh's Smart Operation Panel also supports Quick Authentication. The simple swipe-and-go card-based authentication system is fast and secure, eliminating the need

for users to remember login names and passwords.

The authentication software is pre-installed and only requires the purchase of an optional NFC Reader/Writer. By controlling access to device functions, it prevents sensitive documents from being viewed, copied or sent to authorised users.



3. Sales Highlights

Power and performance

Ricoh's new A3 B&W printer is the most productive in its class. The first 1,200 dpi print is ready in 2.7s and multi-page sets are delivered at 60ppm.

- One-off prints ready in 2.7s (best in class)
- Multi-page document sets delivered at 60 ppm
- Double-sided documents produced at full speed
- Option to expand paper capacity to 4,700 sheets
- Non-stop production with auto tray switching



In-house production centre

It is not just about print speed. Automating manual finishing processes, the SP 8400DN will reduce labour, streamlining production.

- IPDS option supports transactional printing
- Optional folder creases invoices for insertion
- Optional finisher creates punched and stapled sets
- 300k duty cycle ensures reliable performance
- Optional call light helps to maintain productivity



Easy to live with

SP 8400DN is easy to live with. With the lowest TEC rating in its class, it helps to reduce energy consumption and minimise carbon emissions.

- Class-leading TEC (2.8KWh) cuts energy consumption
- Recovers from sleep mode (0.5W) in under 3 seconds
- Noise suppression reduces sound output
- Finger-friendly stapleless finish using hybrid finisher
- Eco-information screen reports green metrics



PC-less printing

SP 8400DN features Ricoh's award winning Smart Operation Panel. Using the 10.1" panel, users can easily browse, preview and print documents.

- Features award winning Smart Operation Panel
- Intuitive interface supports PC-less printing
- 10.1" touchscreen display largest in its class
- Easy to browse, preview and print documents
- Print from the cloud, USB/SD card and server



Support for BYOD (bring your own device)

Employees can print to the SP 8400DN using their smart phones and tablets. To connect, they only need to touch their smart device on the NFC tag.

- Intelligent PC-less print solution
- Smart Device Connector supports NFC and QR code
- Easily connect smart phones and tablets
- Print documents received via email and social media
- Improves access and empowers employees



Workflow enabled

Ricoh's GWNX controller, with its fast Intel processor, manages the workflow. The controller supports enterprise solutions, such as StreamLine NX.

- Powerful intel processor manages the workflow
- Enhance security and automate print processes
- Encrypt and password protect documents
- Lock print and append security information
- Deploy enterprise solutions, like StreamLine NX



4. Product Positioning

- Fast, high quality A3 B&W printer
- Fastest recovery, first page and throughput speed
- Large panel (10.1") supports PC-less printing
- Lowest typical electricity consumption (2.8KWh) saves energy
- In-line folding and finishing options automate production

SP 8400DN is the most productive A3 B&W printer in Ricoh's office range. It delivers professionally presented 1,200 dpi output at express speed. The first page is ready in 2.7 seconds and multi-page documents are produced at a rate of 60 ppm. To save time, the optional internal folding unit will create documents ready for insertion.

SP 8400DN supports IPDS printing and can be used to produce mission critical transactional documents. Boasting the largest operating panel in its class, SP 8400DN also supports PC-less

printing. Simplifying work practices, users can browse and print documents from the cloud, USB/SD memory and the printer's optional internal file server.

SP 8400DN is a dedicated print-only version of Ricoh's top-of-the range MP 6055 MFP. It shares the same appearance, drivers, interface and options as the MFP and can be installed alongside it as part of a uniform enterprise-wide MFP + P print solution. This table shows SP 8400DN's positioning amongst A3 B&W printers.

	Ricoh	HP	Lexmark	Kyocera	Xerox
60 ppm	SP 8400DN (60ppm, 10.1" panel)				
55 ppm		M806DN (56ppm, 4.3" panel)	MS911de (55ppm, 4.3" panel)		
50 ppm	SP 8300DN (50ppm, 4.3" panel) [old model]		W850dn (50ppm, 2-line LCD)	FS-9530DN (51ppm, 2-line LCD)	Phaser 5550DN (50ppm, 6-line LCD)
45 ppm					
40 ppm	SP 6430DN (38ppm, 2-line LCD)	M712dn (41ppm, 4-line LCD)		FS-9130DN (40ppm, 2-line LCD)	

5. Configuration

Mainframe hardware configuration

SP 8400DN is a high speed A3 B&W printer. It features Ricoh's GWNX S16 controller and award winning 10.1" Smart Operation Panel. PCL, PS3 emulation and PDF Direct emulation are included as standard. Genuine Adobe PostScript3, PDF Direct, XML and IPDS printing are offered as upgrades. The mainframe is supplied with a duplex, two 550 sheets paper trays and a 100 sheet bypass. The paper capacity can be extended to 4,700 sheets. In-line finishing options include a multi-folding unit, a 4-bin mailbox, a 1,000 sheet staple/stapleless finisher and a 3,000 sheet staple finisher.

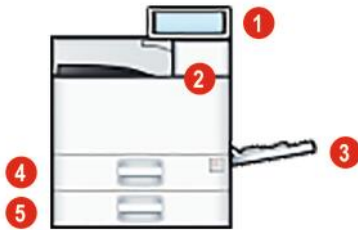

- 1 = 10.1" Smart Operation Panel
- 2 = Duplex (internal)
- 3 = 100 sheet bypass
- 4 = 1 x 550 sheet paper tray
- 5 = 1 x 550 sheet paper tray

Feed and finishing options

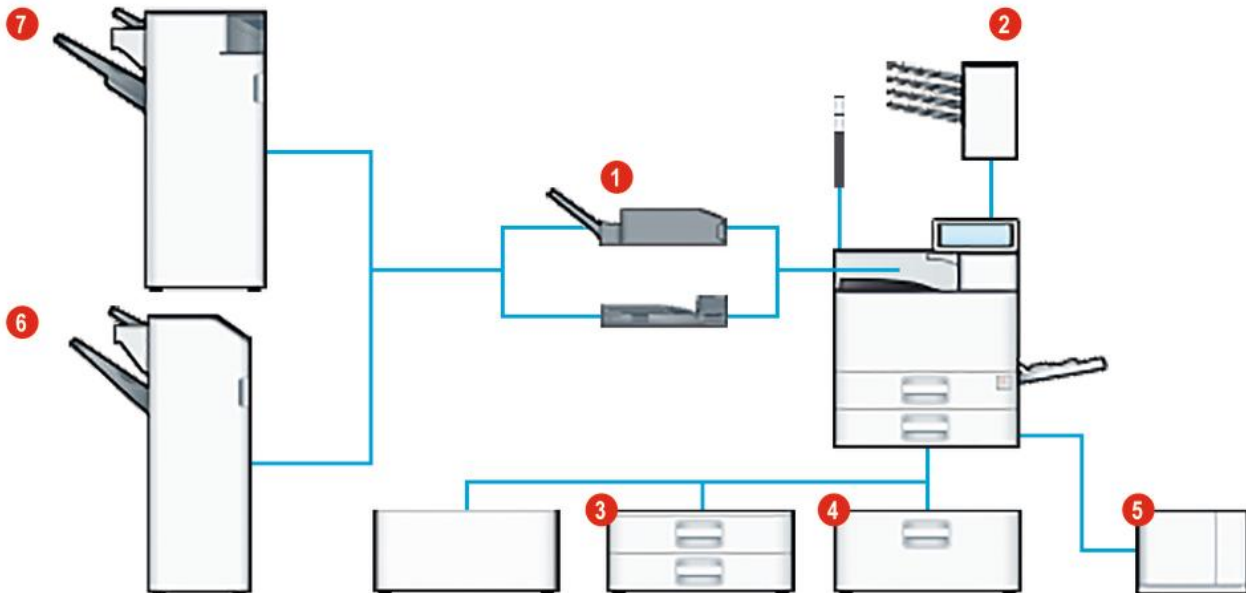

- 1 = Internal multi-fold unit (FD3000)
- 2 = 4 bin mailbox (CS3010)
- 3 = 2 x 550 sheet feed (PB3240), or
- 4 = 2 x 1,000 sheet feed (PB3260)
- 5 = 1,500 sheet LCT (RT3030)
- 6 = 1,000 sheet finisher (SR3210)
- 7 = 3,000 sheet finisher (SR3230)

Functional Configuration - SP 8400DN

Functionality	A3 black-and-white printer
Interfaces	Gigabit Ethernet [10Base-T / 100Base-TX / 1000Base-T] (standard) / USB2.0, IEEE1284, IEEE802.11a/b/g/n, NIC2 Port (options)
Print Drivers	PCL5e/c, 6(XL), PostScript3/PDF Direct [emulation], Media Print (JPEG/TIFF), PjL, RPCS (standard) / IPDS [not available at time of launch], XPS, Genuine Adobe® PostScript®3™, PDF Direct from Adobe® (options)
Memory	2GB RAM (standard) / 320GB Hard Disk Drive (option)
Security	Data Overwrite Security (with optional HDD)
Other	VM Card, NFC Card Reader, Extended USB Board (options)

EDP Codes and Dependencies - SP 8400DN

Category	Item	Product Name	EDP Code	Must Install	Cannot Install
Mainframe	Ricoh branded 60 ppm printer	SP 8400DN	408064	-	-
	NRG branded 60 ppm printer	SP 8400DN	408064	-	-
Operation	Call Light	Attention Light AL3000	407964	-	-
Paper Feed	2 Tray Paper Bank	Paper Feed Unit PB3240	408112	-	LCIT PB3260, Cabinet
	Tandem LCT	LCIT PB3260	408118	-	LCIT PB3240, Cabinet
	Cabinet	Low Cabinet 45	906709	-	LCIT PB3240, LCIT PB3260, RT3030
	Side LCT	LCIT RT3030	416549	LCIT PB3260, LCIT PB3240	-
Finishing	Internal Multi-Fold Unit	Internal Multi-Fold Unit FD3000	417838	-	Bridge Unit BU3070
	4-bin Mailbox	Mail Box CS3010	407965	-	-
	Bridge Unit	Bridge Unit BU3070	417587	Finisher SR3210, Finisher SR320	Internal Multi-Fold Unit FD3000
	1000 Sheet Hybrid Finisher	Finisher SR3210	417483	LCIT PB3260, LCIT PB3240 or Cabinet plus Bridge Unit BU3070 or Internal Multi-Folding Unit FD3000	Finisher SR3230
	EU Punch for SR3210	Punch Unit PU3050EU	416610	Finisher SR3210	Punch Unit PU3050NA/SC
	SC Punch for SR3210	Punch Unit PU3050SC	416611	Finisher SR3210	Punch Unit PU3050NA/EU
	NA Punch for SR3210	Punch Unit PU3050 NA	416609	Finisher SR3210	Punch Unit PU3050EU/SC

	3000 Sheet Finisher	Finisher SR3230	417487	LCIT PB3260, LCIT PB3240 or Cabinet plus Bridge Unit BU3070 or Internal Multi-Folding Unit FD3000	Finisher SR3210
	EU Punch for SR3230	Punch Unit PU3060EU	416613	Finisher SR3230	Punch Unit PU3060NA/SC
	SC punch for SR3230	Punch Unit PU3060SC	416614	Finisher SR3230	Punch Unit PU3060NA/EU
	NA Punch for SR3230	Punch Unit PU3060 NA	416612	Finisher SR3230	Punch Unit PU3060EU/SC
	Output Jogger for SR3230	Output Jogger Unit Type M25	417630	Finisher SR3230	-
Printing	Genuine Adobe PostScript3	PostScript3 Unit Type P13	408096	-	-
	IPDS	IPDS Unit Type P13	408075	-	-
	XPS	XPS Direct Print Option Type P13	408072	-	-
	320GB HDD	HDD Option Type P13	408078	-	-
	VM Card	VM CARD Type P13	408099	-	-
Interfaces	NIC2 Port	USB Device Server Option Type M19	417568	-	Wireless Interface, Parallel Interface
	Extended USB Board	Extended USB Board Type M19	417566	-	-
	Wireless Interface	IEEE 802.11a/g/n Interface Unit Type M19	417493	-	NIC 2 Port, Parallel Interface
	Parallel Interface	IEEE 1284 Interface Board Type M19	417596	-	NIC 2 Port, Wireless Interface
	IC Card R/W (NFC)	NFC Card Reader Type P11	408088	-	IC Card Reader Table
	IC Card Reader Table for Printer	External NFC Card Reader Bracket Type P11	408066	-	-

Consumable EDP Codes - SP 8400DN

Category	Brand	Item	Product Name	EDP Code
Toner	Multi Brand	Black Toner	Toner SP 8400E	821277
Maintenance Kit	Multi Brand	Maintenance Kit A (Includes Drum Unit, Transfer Unit and Waste Toner Bottle)	Maintenance Kit SP 8400A	408107
		Maintenance Kit B (Includes Fusing Unit)	Maintenance Kit SP 8400B	408109
Staples	Ricoh	Staple Set Cartridge for SR3130, SR3140, SR3160, SR3170, SR3210, SR3230, SR3240	Ricoh Staple Type T	414859
		Staple Refill Cartridge for SR3130, SR3140, SR3160, SR3170, SR3210, SR3230, SR3240	Ricoh Refill Staple Type T	414865
	NRG	Staple Set Cartridge for SR3130, SR3140, SR3160, SR3170, SR3210, SR3230, SR3240	Staple Type T	414861
		Staple Refill Cartridge for SR3130, SR3140, SR3160, SR3170, SR3210, SR3230, SR3240	Refill Staple Type T	414867
	Infotec	Staple Set Cartridge for SR3130, SR3140, SR3160, SR3170, SR3210, SR3230, SR3240	Infotec Staple XVI/ 1(Set Cartr.)	414860
		Staple Refill Cartridge for SR3130, SR3140, SR3160, SR3170, SR3210, SR3230, SR3240	Infotec Staple XVI/ 2(Refill)	414866

6. Target Markets

Ricoh's powerful new A3 B&W printer is designed for mission critical print applications. Effortlessly productive and reliable, the SP 8400DN produces professionally presented black and white output at pace. It supports IPDS printing and can be used as a dedicated in-house production facility for high value / high volume transactional documents. It can also be deployed as a shared departmental printer in the general office.

SP 8400DN - Horizontal Markets

SP 8400DN can be deployed as a departmental printer in the general office. Printing at a speed of 60 ppm, it will meet the demanding black and white print requirements of large workgroups. Planners, accountants and project managers and will welcome the A3 print facility. And, sharing the same drivers, interface and options as Ricoh MFPs, it can be installed as part of a uniform enterprise-wide MFP + P print solution.

SP 8400DN – Vertical Markets

SP 8400DN can be deployed as dedicated in-house facility for production of mission critical documents (where paper documents are essential part of business process, such as in logistics). The printer supports IPDS printing and can print from mainframe applications. Vertical markets will include warehouses and logistical hubs, printing despatch notes and invoices; and financial institutions, producing personalised customer-facing documents, such as proposals and statements.

The SP 8400DN features Ricoh's award winning Smart Operation Panel. The intuitive interface supports PC-less printing. Using the large 10.1" panel, general office workers and workers in dedicated print environments can browse and print documents from a variety of sources, including the web, USB/SD card memory and the printer's optional file server.

Business Driver	Ricoh Solution	Customer Benefit
Print mission-critical documents	→ Dedicated IPDS enabled printer: 2.7 second 1st page and 60 ppm throughput.	→ Fast, accurate and reliable production of mission-critical documents.
Improve business efficiency	→ Shared departmental print resource: fast 60ppm throughput, A3 print facility and automated in-line finishing.	→ Fast and cost effective production of general office documents.
Facilitate PC-less printing	→ Browse and print from the web, USB/SD memory and HDD using large-screen 10.1" Smart Operation Panel.	→ Enables PC-less employees, such as drivers and warehouse workers, to print mission-critical documents.
Support BYOD (bring your own device)	→ Easy connection to smart phones and tablets using Smart Device Connector app.	→ Enables users to print securely from their smart phones and tablets.
Safeguard document security	→ Securely 'lock' print until it is released by the originator and append security information to every document.	→ Document security is easily enforced using standard and optional security features.
Control/reduce print expenditure	→ Deploy enterprise workflow solutions and enforce intelligent print rules such as duplex default.	→ By implementing intelligent rules, it is easy to minimise expenditure.
Optimise document infrastructure	→ Right-size the document infrastructure by selecting appropriate models (printer/MFP, colour/mono, fast/slow).	→ Improve productivity, enhance user satisfaction and reduce cost.



7. Key Features

Key Features - SP 8400DN		
Mainframe		
Feature	Advantage	Benefit
I-Style design	The printer follows Ricoh's I-Style design concept. Operational areas, such as the touchscreen display and delivery area, are emphasised in black.	Smart appearance accentuates compact design and looks professional in a modern work environment.
Uniform platform *** Enterprise Solution ***	SP 8400DN has a similar appearance and uses the same print drivers and user interface as Ricoh's A3 MFPs.	Can be sold as part of a uniform enterprise wide solution. Users are instantly familiar with the intuitive operating system.
Print dedicated	SP 8400DN is dedicated high speed / high quality print solution.	There is no need to wait whilst other users scan and copy documents. SP 8400DN effortlessly meets print demand, improving productivity.
Modular options	There is a selection of modular options for the new printer, including paper banks, a 4-bin mailbox, a folding unit and two finishing systems.	Using modular options, the printer can be tailored to operational need.
Robust build quality	Built for heavy uninterrupted use.	Supports non-stop production of mission-critical documents.
Productivity		
Feature	Advantage	Benefit
Instant on	When touched, the Smart Operation Panel instantly recovers from sleep mode (<1 sec).	Saves time and improves user productivity.
Quick warm up	The printer is ready to use within 25 seconds of powering up.	No hanging around waiting for the printer whilst it powers up.
Instant recovery	SP 8400DN recovers from energy-saving sleep mode in just 3 seconds.	Saves time and reduces energy consumption.

Fast first page *** Best in Class ***	Fastest 1st page print speed in class. The new printer delivers its first page in just 2.7 seconds.	Saves time in mission-critical environments. With no waiting time, the printer becomes part of the process and not a bottleneck.
Full speed duplex	The integral duplex runs at full engine speed.	There is no reduction in productivity when printing two-sided.
Operation		
Feature	Advantage	Benefit
Next Generation (GWNX) controller	The new printer features the latest version of Ricoh's GWNX controller architecture.	Common interface automates workflow, establishes governance and enforces security.
Intel Processor	The new printer has a fast 1.46GHz Intel processor.	Quickly processes data rich print files.
10.1" touchscreen panel *** Easy to Browse ***	Large, high visibility touchscreen panel - there are no hard buttons - can be tilted for easy operation.	Easily accessible, no matter where the printer is located and instantly familiar to users of other Ricoh devices.
Smart Operation Panel	The touchscreen is navigated with touch gestures, much like a smart phone or tablet.	Simplifies operation, improving the user experience.
Intuitive User Interface	Intuitive applications, navigated using flick and pinch-in/out gestures, make it easy to select copy, scan and fax settings.	Simplifies operation and provides a smooth transition from Ricoh's 'classic' user interface.
Customisable home screen	Users can customise the interface, changing the wallpaper, dragging shortcuts to the home screen, installing useful widgets and downloading additional workflow applications directly from Ricoh's Application Site.	Customisation helps to improve the user experience.
Application Site	The Application Site icon on the Smart Operation Panel is the gateway to Ricoh's Application Site. Tapping on the icon, the user can browse and install additional workflow applications.	Tailor the printer to operational requirements and simplify everyday document processes.
Home screen folders	Folders can be created on the home screen. This allows icons to be organised logically and located quickly. For repetitive tasks requiring multiple settings, storing all the required program icons in the same folder can save a lot of time.	Simplifies navigation, saving time.
Intelligent widgets	Widgets can be added to the home screen that show the date and time, environmental metrics, toner supply levels, language settings and which notify users of incoming fax messages.	Essential information is available at glance.
Web browser *** PC-less Printing ***	A standard feature of the Smart Operation Panel, the Web Browser provides direct access to the web. It can be used to view and print content and install workflow applications. With its inbuilt speaker, it can even be used to watch training videos.	Enables easy access to cloud-based content.

Workflow enabled	The Smart Operation Panel provides an intuitive interface for optional workflow solutions, such as StreamLine NX.	Easily implement enterprise workflow and cost management solutions.
Paper Handling		
Feature	Advantage	Benefit
A3 print engine	SP 8400DN supports paper formats from A6 to A3 and paper sizes from 90 x 148 mm to 304.5 x 600 mm.	Single device can meet A4 and A3 print requirements.
4,700 sheet (max) paper capacity *** Best in Class ***	The standard paper capacity of 1,200 sheets (2 x 550 sheet trays + 100 sheet bypass) can be expanded to 4,700 sheets (maximum) with the addition of a 2 x 1,000 sheet tandem LCT and a 1,500 sheet side LCT.	Hold different paper formats and stock online and reduce downtime related to paper replenishment.
Auto tray switching	The printer can automatically switch from one tray to another.	Replenish paper without interrupting the print process.
Thick paper support	The regular paper trays, optional paper banks and LCTs support paper weights of 60 to 300 gsm, the bypass supports paper weights of 52 to 300 gsm and the duplex supports paper weights of 52 to 256 gsm.	Print reliably onto letterhead paper, bond stock and other non-standard media.
Envelope printing	The standard paper trays and bypass tray support multi-feeding of envelopes.	Speed mailing process by printing addresses onto envelopes.
100 sheet multi-bypass	The standard multi bypass tray will hold 100 sheets of paper.	Quickly feed non-standard media such as letterhead paper, labels and envelopes.
Finishing Options		
Feature	Advantage	Benefit
Internal Multi-Fold Unit (FD3000) *** Unique to Ricoh ***	A compact multi folding unit can be installed within the catch tray. Automated folds include Z-fold, half-fold, outer three-fold and inner three-fold.	Fold mission critical documents, such as invoices and statements, ready for insertion. No need to outsource or use manual labour, saving time and money.
4-bin Mailbox	A 4-bin mailbox can be attached to the top of the printer.	Print can be delivered to a specific mailbox, reducing the risk of confidential information being mislaid.
1000 Sheet Hybrid Finisher (SR3210) *** Unique to Ricoh ***	This is a hybrid finisher. It will bind document sets of up to 5 sheets using a stapleless punch-press action and staple larger document sets using a conventional staple action. It has a 1,000 sheet shift tray, a 250 sheet proof tray and can staple up to 50 sheets. A 2/4 hole punch is offered as an option.	This finisher is unique to Ricoh. Small documents sets can be bound using a low cost, eco-friendly punch-press action, whilst larger documents sets can be securely stapled.
3000 Sheet Finisher (SR3230)	This is a productive high capacity staple finisher. It has a 3,000 sheet shift tray, a 250 sheet proof tray and can staple up to 50 sheets. A 2/4 hole punch is offered as an option.	This is a heavy duty staple finisher which supports long print runs and provides capacity for long periods of unsupervised production.
Connectivity		
Feature	Advantage	Benefit

Network ready	The new printer is equipped with a gigabit ethernet interface and there are parallel and wireless interface options.	Workgroup users can share the same device, improving access.
USB device server	The USB device server provides a secondary network interface port which allows the printer to be connected simultaneously to two print networks.	Support customers, such as banks, hospitals and schools, who run separate open and closed networks.
Wireless Direct *** Supports BYOD ***	The Smart Operation Panel is equipped with a WiFi card that supports fast and secure connection with smart devices.	Supports Bring Your Own Device (BYOD) by enabling easy connection with smart phones and tablets.
Smart Device Connector	A free app that enables users to connect their smart devices to a Ricoh printer, MFP, interactive whiteboard or projector using NFC, QR code or Bluetooth. Once connected to the printer, their smart devices can be used as an interface to print documents.	Improves access to technology, simplifies information exchange and facilitates mobile working.
Smart Device Print and Scan	Free Ricoh app enables documents to be printed from and scanned to smartphones and tablets.	Improves access and mobility.

Printing

Feature	Advantage	Benefit
Point and print icons	The standard PCL and PS3 print drivers have graphic icons which allow single click selection of complex settings.	Simplifies the print process, saving time.
PS3 emulation *** Included in Price ***	The new printer includes PS3 emulation as standard.	Reduces configuration costs whilst supporting the need to print PostScript and PDF files.
PDF Direct emulation	PDF documents can be printed directly to the printer. The files are processed by the printer rather than the PC.	Releases computer resource and reduces network traffic.
Genuine Adobe PostScript 3 (option)	A genuine PostScript driver is available as an option.	Has a wider range of fonts than the standard PS3 clone, improving the accuracy of PostScript printing.
XPS direct print (option)	The new printer also support XPS direct print. XPS is an XML based document format, similar to PDF, which is promoted by Microsoft.	Compatible with newly emerging print format.
IPDS print (option)	The genuine IPDS option enables fast, error-free bi-directional communication with mainframe (host) computer systems.	Improve ROI by printing transactional data such as invoices and statements.
Scheduled print	Users can specify a time at which documents are to be printed.	Reduces bottlenecks. Time-consuming jobs such as invoice runs can be scheduled to run overnight or at the weekend.

Portable Media

Feature	Advantage	Benefit
USB/SD card reader	There is a USB/SD card reader located to the side of the control panel.	Improves access by enabling walk up users to print from flash memory.

Print from Storage Media	Documents stored on a USB/SD card can be previewed on the Smart Operation Panel and printed. The intuitive user interface helps the user to select appropriate print settings and to preview and print documents.	Documents held on portable media are printed more easily.
Multiple file selection	It is possible to select and print multiple JPEG, TIFF or PDF files held in the same folder of a USB/SD card.	Speeds production with the user able to print multiple files in a single operation.
Security		
Feature	Advantage	Benefit
NFC Card Reader (option)	An optional NFC (near field communication) card reader can be installed inside the top panel of the printer. The reader supports ID card authentication.	Protects security by requiring ID card based authentication.
Quick Authentication	Ricoh's swipe-and-go card-based authentication software is pre-installed and only requires the purchase of an optional NFC Reader/Writer.	Simplifies login whilst safeguarding network and document security.
Data Overwrite Security (requires optional HDD)	Overwrites temporary data held on the hard drive up to nine times with random data.	Protects security by ensuring that temporary data cannot be recovered.
HDD Encryption (requires optional HDD)	Encrypts the address book, authentication information and stored documents.	Protects security by encrypting documents.
Quota scheduling	The administrator can limit the output of individual users and user groups by setting page count limits. This feature now allows quotas to be shared across multiple Ricoh devices.	Establishes governance over the print environment and reduces print volume.
Banner page print	A job sheet can be printed before a print job that identifies the originator.	Makes it easier to identify work in a busy environment.
Mandatory hold print	When mandatory hold print is activated by the administrator, print output is held in the document server until released at the printer by the originator.	Protects confidentiality and reduces waste.
Mandatory security information	Automatically append security information such as the user ID, date, time, IP address and printer serial number to every document printed.	Improves document security by establishing a printed audit trail.
Environment		
Feature	Advantage	Benefit
Power on/off timer	The power on/off timer switches the machine on and off at specified times.	Ensures the machine is ready for use and saves energy by switching the machine off when it is not required.
Remote shutdown	If the on/off timer isn't activated and the printer is left on, the administrator can shut it down remotely.	Additional control feature which helps the administrator conserve energy.
Sleep Mode	In sleep mode, SP 8400DN consumes just 0.5W of power.	Reduces energy consumption.

Eco-information screen	A pop-up, visible at the control panel, reports green metrics, such as the number of double sided prints.	Encourages sustainable print behavior.
Low TEC *** Best in Class ***	SP 8400DN is the most energy efficient printer in its class, with a TEC rating of just 2.8KWh.	Save energy and reduce carbon emissions by using energy efficient technology.
Energy Star v2, BAM and EPEAT Gold	SP 8400DN is compliant with the latest environmental standards, including Energy Star v2, Blue Angel Mark (BAM) and EPEAT Gold.	Don't just take Ricoh's word for it; third party certification proves that these devices are eco-friendly.



8. Specifications

SP 8400DN Specifications		
General Specifications		
Warm-up time	21 seconds	
First output speed	B/W	2.2 seconds
Continuous output speed	B/W	A4
Memory	Standard	2 GB
HDD	320 GB (Optional)	
Duty cycle	300,000 prints per month	
Life	5 years or 3,200,000 outputs	
Duplex	Yes	
Dimensions (W x D x H)	587 x 653 x 720 mm	
Weight	57 kg	
Power source	220 - 240 V, 50/60 Hz	
Printer Specifications		
Printer language	PCL5c	
	PCL5e	
	PCL6(XL)	
	Adobe® PostScript® 3™	
	XPS	
	IPDS	
	PDF Direct from Adobe®	
	Mediaprint (JPEG/TIFF)	
Print resolution	Maximum	1,200 x 1,200 dpi
Interface	Standard	SD slot
		USB Host I/F
		Ethernet 10 base-T/100 base-TX/1.000 base-T, USB 2.0
		Wireless LAN (IEEE 802.11a/b/g/n)
		Bluetooth
		USB Server for Second Network Interface
		Bi-directional IEEE 1284/ECP

Network protocol	TCP/IP	IP v4
		IP v6
	IPX/SPX (option)	
Windows® environments	Windows Vista/7/8.1/10/Server2008/2008R2/2012/2012R2/2016	
Mac OS environments	Macintosh OS X v10.9 or later	
UNIX environments	UNIX Sun® Solaris	2.9, 2.10
	HP-UX	11.x, 11i v2/3
	SCO OpenServer	5.0.7/6.0
	RedHat® Linux	6.x, 7.x, 8.x, 9.x
	IBM® AIX	5L V5.3, V6.1, V7.1
SAP® R/3® environments	SAP® R/3®	SAP® R/3 3.x® or later
		mySAP ERP 2004 or later
		SAP Enterprise
Other supported environments	NDPS Gateway	
	AS/400® using OS/400 Host Print Transform	
	IBM iSeries	
Printer driver features	Send to document server, Sample print, Locked print, Hold print, Stored print, Store and print, Reduce/enlarge(zoom/scaling), Fit to paper size, Layout (N-up, page per sheet), Duplex, Watermark, Collate, Rotate by 180 degrees, Dithering, Toner saving, Black over print, CLP colour simulation, User ID, User code, Edge to edge print, PDF direct print, Mail to print, Classification code, Bonjour (Rendezvous) support, Windows® Active Directory support, DDNS support, PCL resident font adoption, Tray-parameter change from Web Image Monitor, 1,200 dpi support, Mobile driver, XPS support, WS printer, Wireless LAN interface option, Media Direct Print (print from USB), Media Direct Print (print from SD), Security Marking Type, Embed Barcode to Print Original File, Auto Job Promotion, AirPrint, Poster Print, WPS (WiFi Protected Set-up) support	
Network interface	Ethernet 10 base-T/100 base-TX/1.000 base-T	
	Wireless LAN (IEEE 802.11a/b/g/n)	
Paper Specifications		
Recommended paper size	Standard paper tray(s)	A3, A4, A5, A6, B4, B5, B6
	Bypass tray	A3, A4, A5, A6, B4, B5, B6
Paper input capacity	Standard	1,200 sheets
	Maximum	4,700 sheets
Paper output capacity	Standard	500 sheets
	Maximum	4,000 sheets

Paper weight	Paper tray(s)	52 - 300 g/m ²
	Bypass tray	52 - 300 g/m ²
	Duplex	52 - 256 g/m ²
Security Specifications		
Network user authentication		
IP address filtering		
HDD Data Overwrite Security (with optional HDD)		
HDD encryption (with optional HDD)		
Authentication	Windows® authentication	
	LDAP authentication	Kerberos
	Basic authentication	
	User code authentication	
	802.1.x wired authentication	
	Integration server authentication	
	SMTP authentication	
	POP before SMTP	
Encryption	Authentication password encryption	
	SSL communication	
	S/MIME	
	IPsec communication	
	HDD encryption	
	Type A	
	Locked print password encryption	
	SNMPv3 (SDM)	
	Authentication password encryption	
	WPA2 (Wireless LAN)	
Secure print		
Encrypted secure print		
IP Sec		
Secure Sockets Layer (SSL)		
IPv6		
Transport layer security		

Removable HDD		
Network security		
Quota Setting/Account Limit		
SMTP over SSL		
Security for IEEE802.11i,w		
NIB access control		
Protect stored documents (DS)		
Environmental Specifications		
Sound power level (mainframe only)	Stand-by	30.7 dB
	Printing	65.2 dB
Sound power level (full system)	Printing	71.2 dB
Sound pressure level (mainframe only)	Stand-by	21.2 dB
	Printing	52.5 dB
Sound pressure level (full system)	Printing	58.0 dB
Power consumption	Maximum	1,780 W
	Operating power	821.7 W
	Ready mode	43.4 W
	Sleep mode	0.89
	TEC (Typical Electricity Consumption)	2.67 kWh
Recovery time from stand-by mode	7.9/7.9/7.9/8.0/8.4/8.8 sec.	
Operating temperature	-30°C - 40°C	
Operating humidity	85%	
Options		
2 x 550-sheet paper tray		
2,000-sheet large capacity tray		
1,500-sheet side large capacity tray		
Bridge unit		
1,000-sheet Hybrid finisher		
3,000-sheet finisher		
Punch kits		
Caster table		
Bi-directional IEEE 1284		

Wireless LAN (IEEE 802.11a/g/n)		
Key counter bracket		
Card reader bracket		
Unicode Font Package for SAP		
Smart Card Reader Built-in Unit		
Enhanced security HDD		
External keyboard bracket		
NFC Card Reader		
USB Device Server		
Extended USB board		
Internal multi-fold unit		
Consumable Specifications		
Toner yield (ISO 19752)	Black	51,000 prints



9. Service and Supplies

SP 8400DN has a low total cost of ownership and can be self-maintained or included in a PpP service contract.

PpP servicing offers the following customer advantages:

- Expert service provision
- Transparent, pre-agreed 'click' price
- Includes toner, maintenance parts and labour
- Accurately metered pay as you go billing

When serviced on a self-maintained basis, the operator/administrator will need to replace maintenance parts as well as replenishing toner. The maintenance parts are easy to install.

Maintenance kit A, which includes the drum unit, transfer unit and waste toner bottle, has a target yield of 160,000 pages.

Maintenance Kit B, which includes the fuser unit, has a target yield of 320,000 pages.

The new printer is designed to offer reliable performance in mission-critical environments. With a maximum monthly volume of 53,333 prints and a monthly duty cycle of 300,000 prints, it can support a wide range of print volumes and will reliably handle large peaks in volume.

Using @Remote, SP 8400DN can be monitored in real-time, enabling service agents, helpdesk staff and administrators to identify issues before they become apparent to users and to deliver consumable items, such as toner, in advance of need.

Consumable yields and service parameters are provided below:

Service and Supply Specifications - SP 8400DN		
Consumable Yield	Toner SP 8400E	51,000 prints / bottle (ISO/IEC 19752)
	Maintenance Kit SP 8400A	160,000 pages (A4, 6%, 5 pages per job)
	Maintenance Kit SP 8400B	320,000 pages (A4, 6%, 5 pages per job)
	Ricoh Staple Type T	1 x 5,000 shots
	Ricoh Refill Staple Type T	2 x 5,000 shots
	Staple Type T	1 x 5,000 shots
	Refill Staple Type T	2 x 5,000 shots
	Infotec Staple XVI/1(Set Cartr.)	1 x 5,000 shots
	Infotec Staple XVI/2(Refill)	2 x 5,000 shots

Document Volume	Average Monthly Volume	12,000 pages
	Maximum Monthly Volume	53,333 pages
	Duty Cycle	300,000 pages per month
Service Life	Target Life (Mainframe)	5 years or 3.2 million pages, whichever comes first

Sales Guide SP 840DN

RICOH
imagine. change.

www.ricoh-europe.com

The facts and figures shown in this brochure relate to specific business cases. Individual circumstances may produce different results. All company, brand, product and service names are the property of and are registered trademarks of their respective owners. Copyright © 2017 Ricoh Europe PLC. All rights reserved. This brochure, its contents and/or layout may not be modified and/or adapted, copied in part or in whole and/ or incorporated into other works without the prior written permission of Ricoh Europe PLC.